

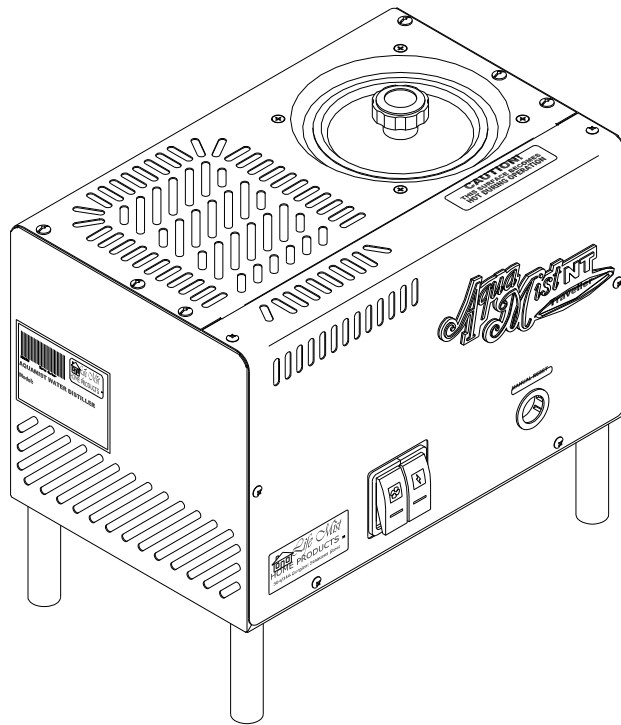

Traveller Owner's Guide



LifeMist Home Products Headquarters
10331-105 St.
Westlock, AB Canada
T7P 2H7

<http://www.lifemist.com>
Phone: Your Local Dealer
FAX: Your Local Dealer

**Please Read Owners' Guide
completely
before installing or operating
your
LifeMist Distiller.**

Introduction

Congratulations on the purchase of the most advanced water distiller in the industry! When installed and maintained properly, your LifeMist Water Systems water distiller will provide years of safe, trouble free service. It is important to observe and follow the safety and maintenance instructions carefully. If you have any questions or concerns regarding installation or operation of your water distiller, please contact your dealer.

All 120 VAC LifeMist Water Systems Water Distillers are certified to cCSAus Classes 2831-02 and 2831-82 under the Canadian and American Electrical Code.

All Water distillers are factory tested with a high voltage 'Dielectric Strength Test' and ground fault test prior to shipping.

LifeMist Water Systems Water Distillers have been tested by EnviroTest Laboratories which found the water distillation units to be very effective water treatment systems capable of removing both harmful pathogens and toxic chemicals from water. In their study, all pathogens were eliminated and none were found in the distilled water. The water distillation system also effectively removed all of the soluble inorganic chemicals tested. Removal efficiencies of 99% or greater were achieved for almost every chemical tested.

All LifeMist Water Systems Water Distillers are operated and tested at the factory and have produced distilled water to make sure all components are functioning properly. All water distillers are wiped clean before shipping, but there may be a water ring inside the boiling tank. There may also be an off-colour line at the seams of the boiler tank. This is caused by the TIG welding process used during manufacturing. This is normal and is not a sign of a problem. Follow all the **Before Initial Water Distiller Operation** procedures and you will have pure water in no time.

Your LifeMist Water Systems Water Distiller must be installed according to any Local, State or Provincial Regulations.

Records

Please record all of the important information below to assist you and the service center in case there is any service work required in the future. All of the information is required to properly identify your water distiller and will make servicing much easier. The information is located on the serial plate on the side of the water distiller head. The **Serial Plate Location Diagram** below shows sample serial plates.

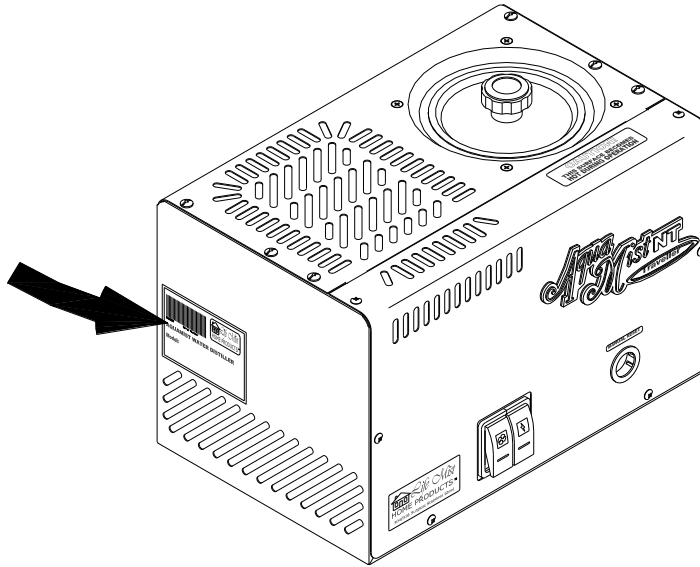

Distiller Head

Serial Plate Location Diagram

Distiller Head:

Model: Traveller

Series:

eg: 0001

Serial Number:

eg: 0501234

Date of Purchase: _____

LifeMist Water Systems Water Distiller Warranty

- The warranty for your LifeMist Water Systems Water Distiller covers defects in materials for five (5) years on all parts and labour to the original purchaser.
- Stainless Steel parts are covered by a 50 year pro rated warranty. This covers all stainless steel parts such as the boiling tank. With this warranty it is the responsibility of the distiller owner to properly maintain the distiller. If there is any misuse or abuse the warranty will be void.
- LifeMist Water Systems does not warrant any transportation charges incurred to complete the repair. The distiller owner is responsible for all shipping charges to and from the service center.
- Warranty is void if the distiller is found to have been consumer damaged or misused, caused by acts of God, unauthorized alteration, repair or vandalism.

Important Safety Precautions

When using electrical appliances, basic safety precautions should always be followed including the following:

- 1. Read all instructions.**
- 2.** Do not touch hot surfaces. Use handles or knobs.
- 3.** To protect against electrical shock do not immerse cords or plugs in water or other liquid.
- 4.** Close supervision is necessary when any appliance is used near children.
- 5.** Do not allow children to operate this appliance.
- 6.** Unplug from outlet when not in use and before cleaning. Allow to cool before putting on or taking off parts.
- 7.** Do not operate any appliance with a damaged cord or plug or after the appliance malfunctions or has been damaged in any manner. Return appliance to the nearest service facility for examination, repair or adjustment.
- 8.** The use of accessory attachments not recommended by the appliance manufacturer may cause injuries.
- 9.** Do not use outdoors.
- 10.** Do not let cord hang over edge of table counter, or touch hot surfaces.
- 11.** Do not place on or near a hot gas or electric burner, or in a heated oven.
- 12.** Extreme caution must be used when moving an appliance containing hot water.
- 13.** Always attach plug to appliance first, then plug cord into the wall outlet. To disconnect, turn any controls to "off", then remove plug from wall outlet.
- 14.** This appliance is intended for household use.
- 15.** Save these instructions.

Additional Safety Recommendations

- 1.** Always unplug appliance before servicing.
- 2.** Do not use extension cords with appliance.
- 3.** Ensure there is adequate air space around the appliance to allow the heat from the appliance to be removed and supply adequate fresh air for cooling.

LifeMist Water Systems Water Distiller Owners' Summary

The following is a summary of the information contained in this Owners' Guide and required to install and operate your Water Distiller

- 1) Find a good location for installing your Water Distiller – See **Finding a Good Installation Location**.
- 2) Unpack the water distiller and parts - See **Unpacking Your Water Distiller**.
- 3) Assemble the Water Distiller – See **Water Distiller Leg Installation**
Impurities Drain Tube Installation
Boiling Tank Lid Installation
- 4) Steam sterilize boiling tank – See **Steam Sterilization of Water Distiller Head** in the **Maintenance and Cleaning** section.
- 5) Load Charcoal Filter Canister – See **Replacing Charcoal in Post Charcoal Filter Canister** in the **Maintenance and Cleaning** section.
- 6) Follow procedure in **Normal Operation** section.
- 7) Enjoy pure, distilled water!

Water Distiller Features

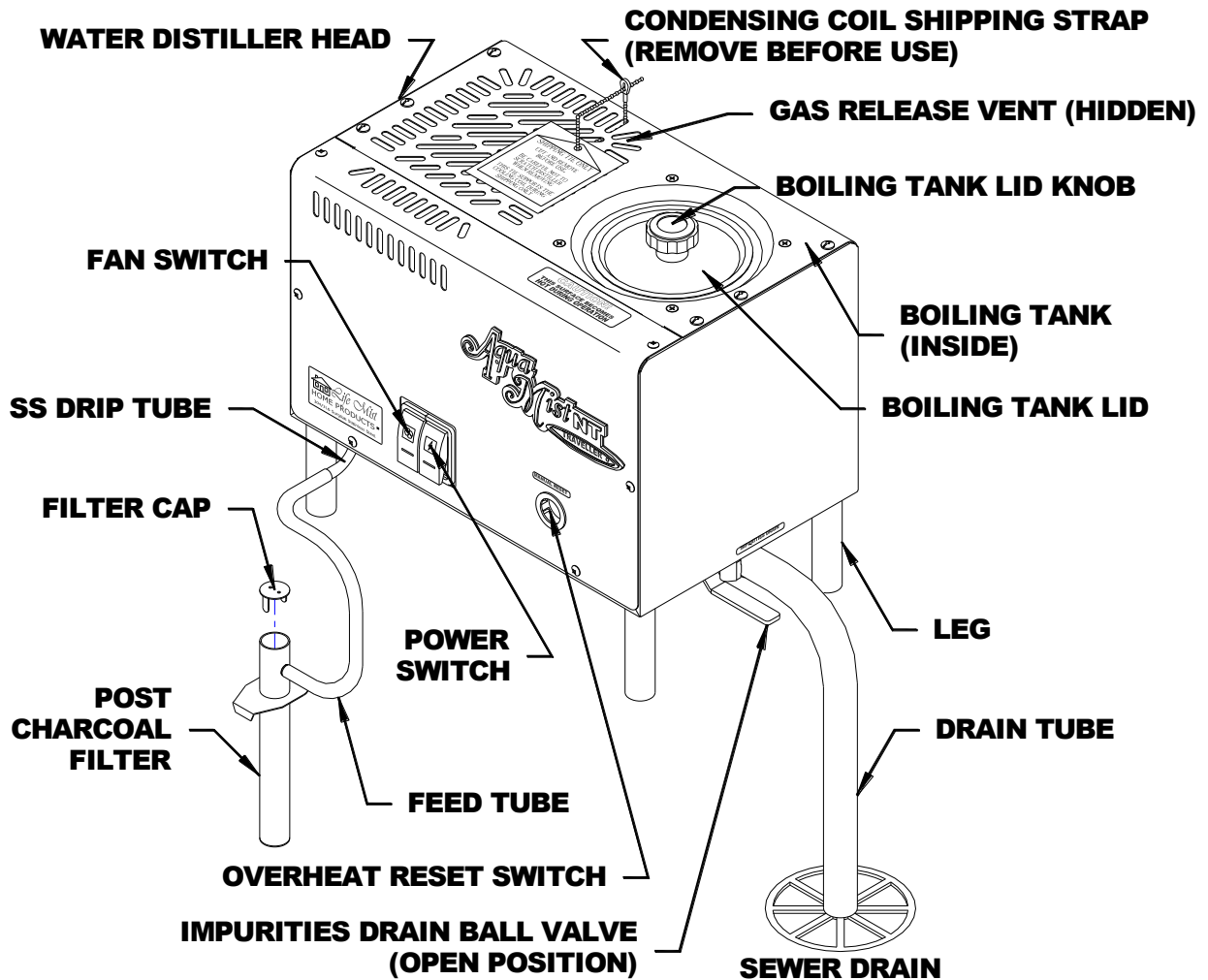

Traveller Distiller Features

10 Factors That Will Affect Your Water Distiller Production

1. Water Volume Measurement

- a) How are you measuring your water? The most accurate is by weight.
1 litre of pure water = 1 kg = 1000 g = 2.2046 lbs
- b) Water distillers are rated in US gallons, NOT Imperial Gallons.
1 US Gallon = 3.785 litres = 3.785 kg = 8.344 lbs = 0.833 Imp. Gallons

2. Line Voltage

The line voltage at the outlet where the distiller is connected should be checked with a voltmeter. Line voltage is often much less than expected, especially in rural areas. Line voltage will also usually drop off dramatically when the daily commercial load hits the grid from approximately 8 am to 5 pm (often when the distiller owner is not home and unable to check the line voltage). Line voltage lower than the distiller rated voltage (on the serial plate) will drastically lower the water production.

3. Fill Water Temperature

The water used to fill the machine may affect the water production. Cooler fill water will take more time/energy to heat to the boiling point than hot water.

4. Ambient Air Temperature

Water distillers with cooling fans must have sufficient ventilation so that the boiled steam can be cooled and condensed into distilled water. Restriction of air flow (such as a closed cupboard) will result in a hot ambient air build up which will not allow all of the steam to condense into distilled water and some water production may escape as steam into the atmosphere through the charcoal filter or volatile gas release vent. This steam loss can also occur in hot summer periods or very warm climates.

5. Heating Element and Boiler Cleanliness

As the water distiller removes impurities, some of the impurities may cling to the boiler tank and the heating element. Any of this scale may build up around the heating element and actually insulate it, which will drastically decrease the thermal efficiency of the heating element and require more time/energy to boil water, which will decrease the water production.

6. Altitude

The water distiller is rated at the altitude of the manufacturer, which is approximately 675 m (2214 ft) above sea level. Locations lower than this (closer to sea level) will have reduced water production due to the higher boiling point of water at higher atmospheric pressures at lower altitudes.

7. Operating Time, Warm-up Period & Suitable Storage

When checking the water distiller production, the start time should be when the first few drops of water have entered the charcoal filter canister. Do not start timing when the distiller turns on as it takes a few minutes for the heating element, boiler tank and water to heat up. The distiller production rating does NOT account for this time, but rather the continuous production after the distiller is up to temperature. Ensure when checking production that you have suitable water storage for holding the amount of water that will be produced.

8. Manual Fill Boiling Tank Fill Level

When checking the water distillation production on manual fill water distillers the amount of water initially poured into the boiling tank will affect the production. Water should be filled to the water level pin so that once the water is hot the maximum amount of water can be distilled without having to heat up and refill. Under-filling the boiler will decrease the amount of water distilled. Again, the warm-up time should not be included in the production rate.

9. Boiling Tank Heating Element

Once all other factors have been eliminated or checked, have an authorized service center check that the proper heating element has been installed in your distiller. Always replace heating elements with the manufacturers supplied heating elements. Other elements are available from hardware stores, home repair centers etc. and look like the same element but they are almost always not the same. Even if the voltage and wattage are the same, they usually have different wattage densities and most likely different element sheath materials, which will result in premature heater burnout in continuous water distillation of raw water. These heating elements will also likely affect your water distillation capacity.

10. Combination of the above Factors.

Often a reduced water distiller's production is a combination of many or all of the above factors. To ensure maximum production from your water distiller, keep your water distiller clean and operate it in a well-ventilated area and use room temperature feed water where possible.

Understanding How Pure Water is Produced

Your water distiller operates the same as Nature's hydrological cycle. See the **Hydrological Cycle Diagram** below. Nature uses the heat of the sun to vaporize surface water and draw it into the atmosphere leaving the impurities behind. As the vapour cools it condenses and returns back to the earth as rain or snow. When rain or snow falls it passes through smog, dust and many other types of contaminants. These contaminants can be picked up by the falling rain or snow. Additional contamination of water can occur when it moves through the ground.

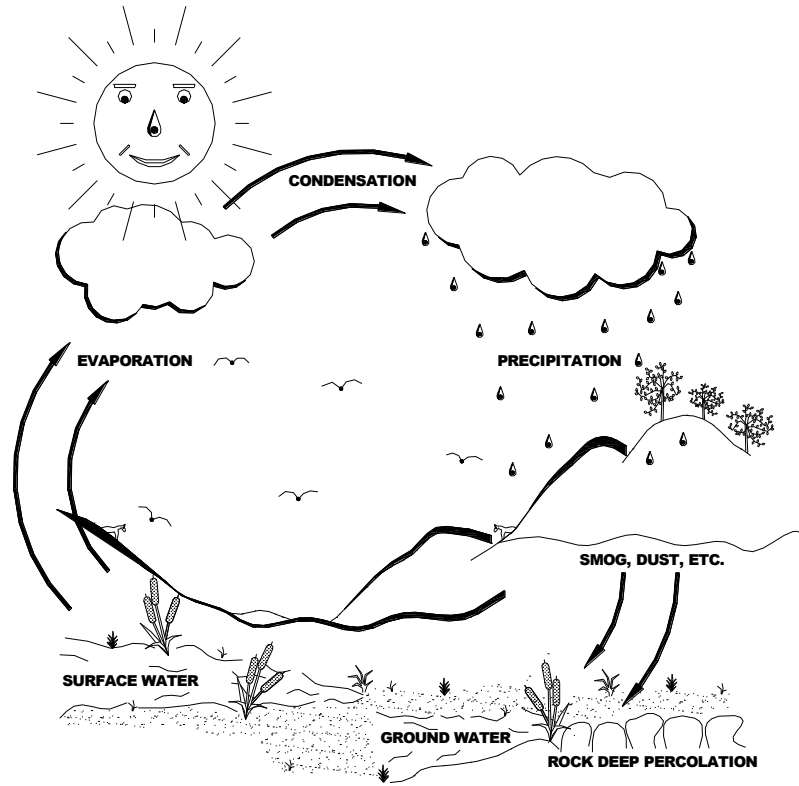

Hydrological Cycle Diagram

Water Distillers complete their own hydrological cycle. The advantage of a water distiller over Nature is that the water is produced in a closed environment free of pollution and contaminants.

Your water distiller uses the boiling tank to heat the feed water to create steam. The steam rises from the boiling tank leaving almost all of the impurities behind. The steam enters the condensing coil and is cooled by the fan. As the steam cools, it condenses into pure distilled water and is stored in a water bottle. The charcoal filter (between the condensing coil and storage container) and the volatile gas vent remove any contaminants that boil at lower temperatures than the boiling point of water. The impurities from the process remain in the boiling tank and are drained to a suitable drain.

Finding a Good Installation Location

Before installing your water distiller it is important to find a good location. Following the points listed below will provide the best location for your water distiller:

- 1.** The water distiller must be plugged directly into a dedicated 120VAC, 15 Amp wall outlet.
- 2.** The water distiller requires sufficient airflow around it to operate. The air is used to cool the water distiller condensing coil. Locate the water distiller in an area that will provide enough room for good airflow. Do not place the water distiller in an enclosed area like a closet.
- 3.** Locate the water distiller where a pail, suitable container or drain can be used for the impurities drain.
- 4.** When unpacking the water distiller and options note the sizes and consider this when picking an installation location.
- 5.** Locate the water distiller away from a bedroom or other area where the noise of the water distiller may be undesirable.
- 6.** Locate the water distiller in an area that is clean and free of dust so the cooling coils remain clean when the fan is drawing fresh air.

Unpacking Your Water Distiller

Your Water distiller has been shipped in one box. The **Water Distiller Box Components** Diagram shown as follows displays all of the parts that will be in the water distiller box.

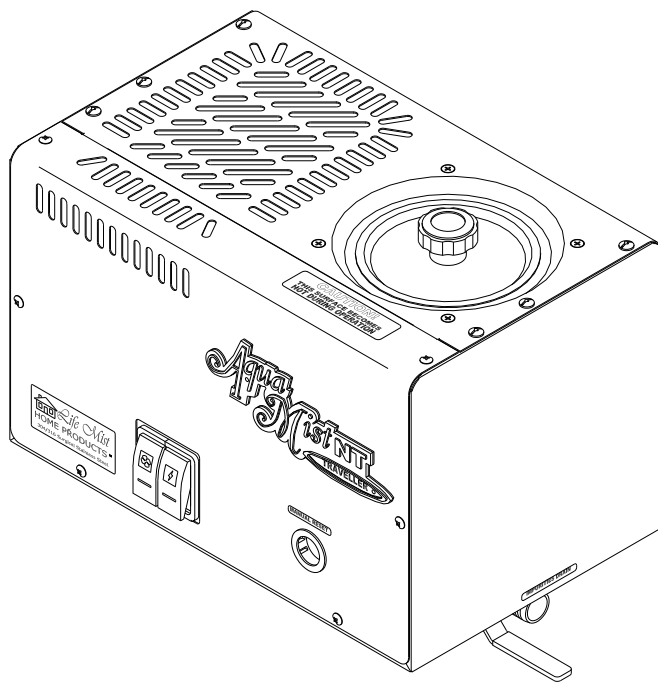

(A) 1x

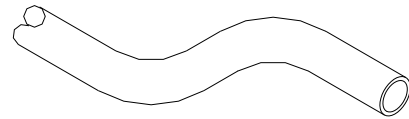

(B) 1x

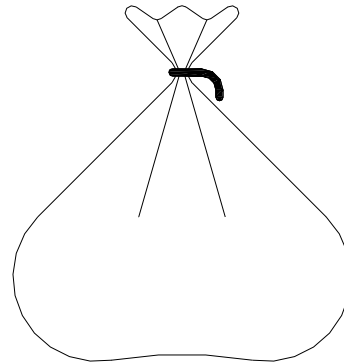

(C) 1x

Water Distiller Box Components Diagram

Water Distiller Box Check List

Check
List

- (A) 1 – Water Distiller Head
- (B) 1 – Impurities Drain Tube
- (C) 1 – Parts

(Water Distiller Parts Bag Components Diagrams shown as follows)

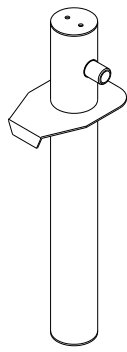

(A) 1x



(B) 1x

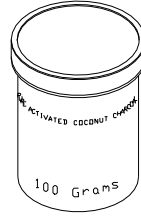

(C) 1x

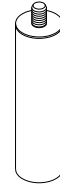

(D) 1x

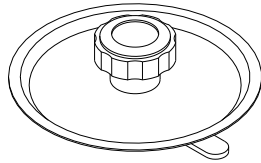

(E) 1x

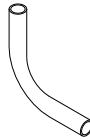

(F) 1x



(G) 1x



(H) 1x

Water Distiller Parts Bag Components Diagram

Water Distiller Parts Bag Check List

Check

Check List	Part No.	
<input type="checkbox"/> (A)	530240	1 – Post Filter
<input type="checkbox"/> (B)	530159	1 – Sample Descaler/Cleaner
<input type="checkbox"/> (C)	530158	1 – Sample Coconut Charcoal
<input type="checkbox"/> (D)	530245	4 – Stainless Steel Legs / with washers
<input type="checkbox"/> (E)	500184	1 – Boiling Tank Lid
<input type="checkbox"/> (F)	530242	1 – Cooling Coil Elbow
<input type="checkbox"/> (G)	052002	1 – 4' Sterilization Drip Tube
<input type="checkbox"/> (H)	080121	1 – Hose Clamp

1. Remove all loose pieces from the water distiller box and save all packaging until all the parts are identified and located.
2. Check inside boiler tank for any parts that may be shipped in that area. If any parts are missing or if you have been given the wrong part, DO NOT return the water distiller unit. Contact your dealer for the required parts. They will be pleased to assist you.
3. Remove all protective plastic from water distiller head and boiling tank lid.

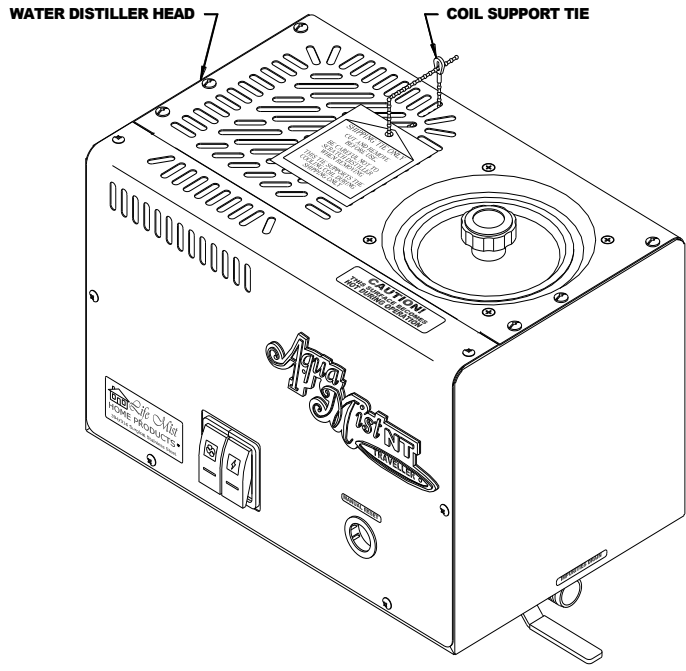

Shipping Tie Removal Diagram

- 4. Refer to **Shipping Tie Removal** Diagram above. Cut/Remove the coil support tie located on the top of the water distiller head. Be careful not to scratch the water distiller when removing. This tie supports the cooling coil during shipping only.

Water Distiller Installation Tools

TOOLS REQUIRED:
For Water Distiller Installation
(A) 5/8" Open End Wrench
(B) Adjustable Wrench

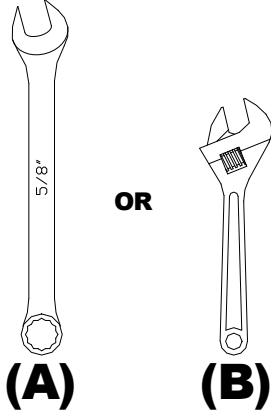

Water Distiller Leg Installation

1. Refer to the **Water Distiller Leg Installation Diagram** shown below. Screw the legs into the bottom of the distiller head.

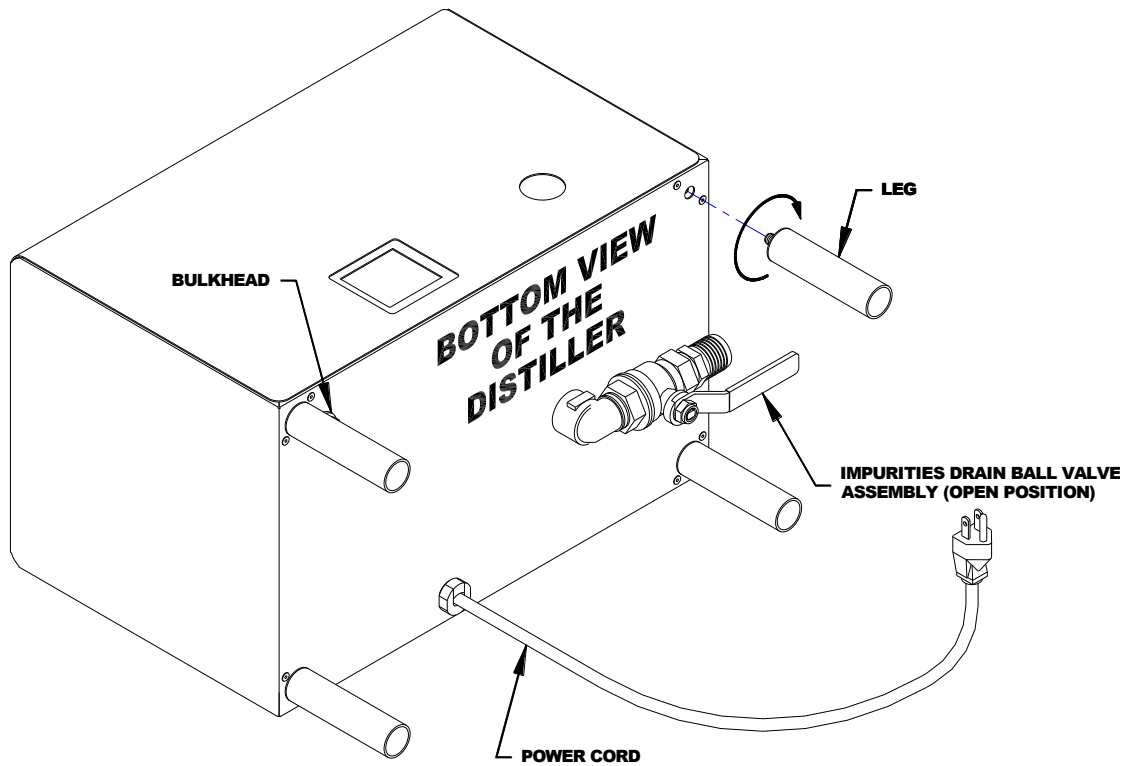

Water Distiller Leg Installation Diagram

Impurities Drain Tube Installation

Refer to the **Impurities Drain Tube Installation Diagram** shown below. Push the drain tube onto the ball valve assembly and secure with gear clamp using a screwdriver. Run the drain tube to a container or a suitable floor drain like the sewer.

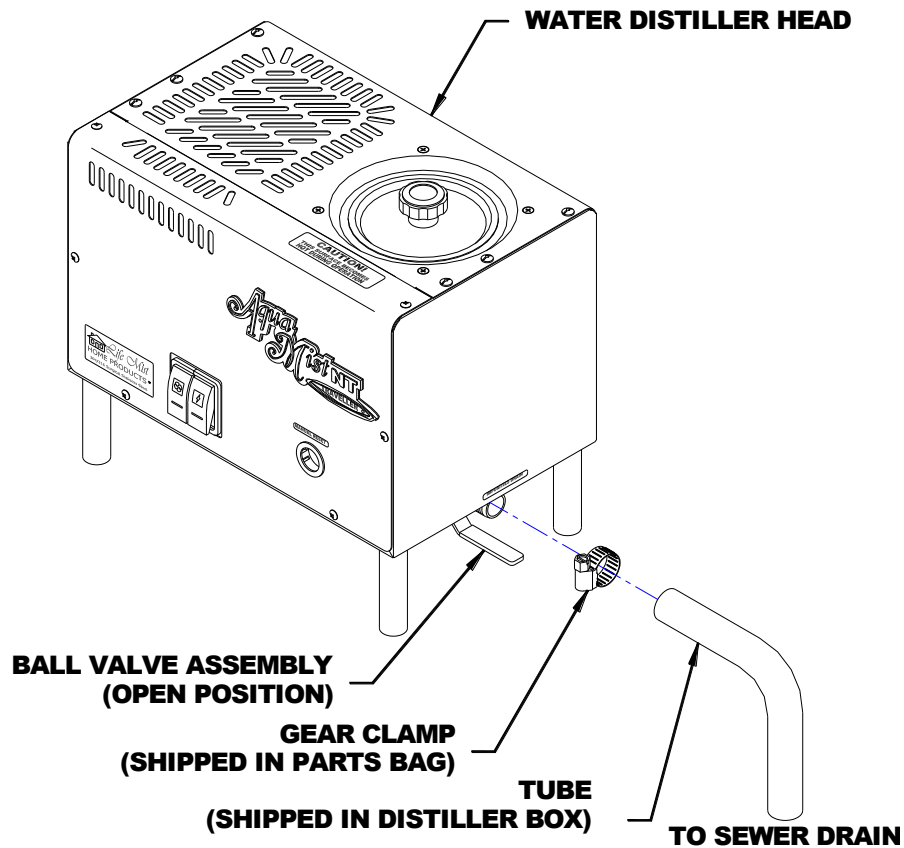

Impurities Drain Tube Installation Diagram

Boiling Tank Lid Installation

1. Remove any protective plastic coating (white, blue or clear plastic) from the lid.

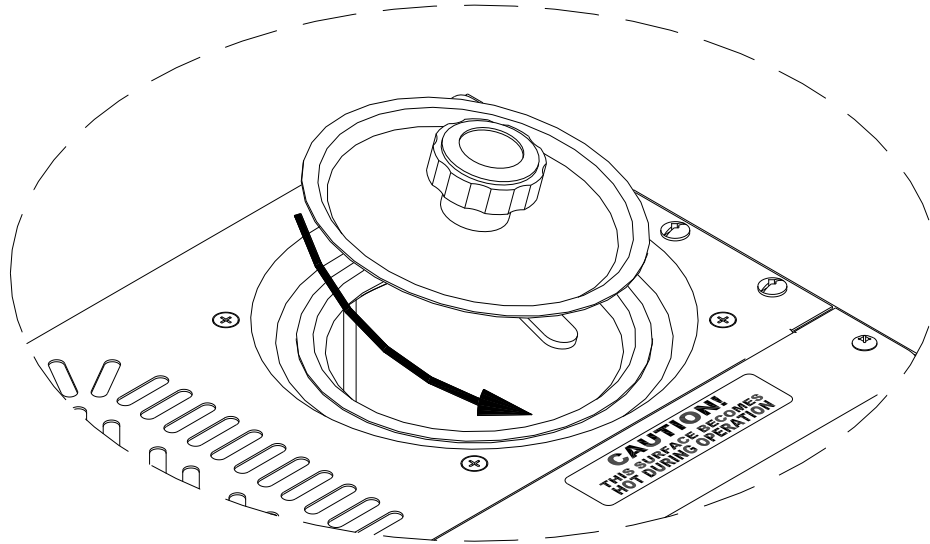

Boiling Tank Lid Operation Diagram

2. Refer to the **Boiling Tank Lid Operation Diagram** above. Take the boiling tank lid in your hand. Hold the Tee Bar bracket and turn the Lid Knob counter-clockwise so that there is $\frac{1}{2}$ " of space between the Tee Bar bracket and the lid.
3. Tip the lid so that the Tee Bar bracket slips under the rim of the boiling tank opening on one side, and then slide the lid so the Tee Bar bracket slips under the other side of the rim. Center the lid.
4. Turn clockwise to tighten the lid onto the boiling tank. The water level pin inside the boiling tank will prevent the lid from turning while tightening. Practise removing and replacing the lid a few times as the lid will need to be removed each time the water distiller is filled or cleaned.

Operation

NOTE: Read all parts of the Owners Guide before operating the water distiller. Follow the Before Initial Water Distiller Operation steps and be sure to complete a Steam Sterilization of the Water Distiller Head & Filter Canister before distilling water for household use for the first time or after a period of storage or non-use.

Controls

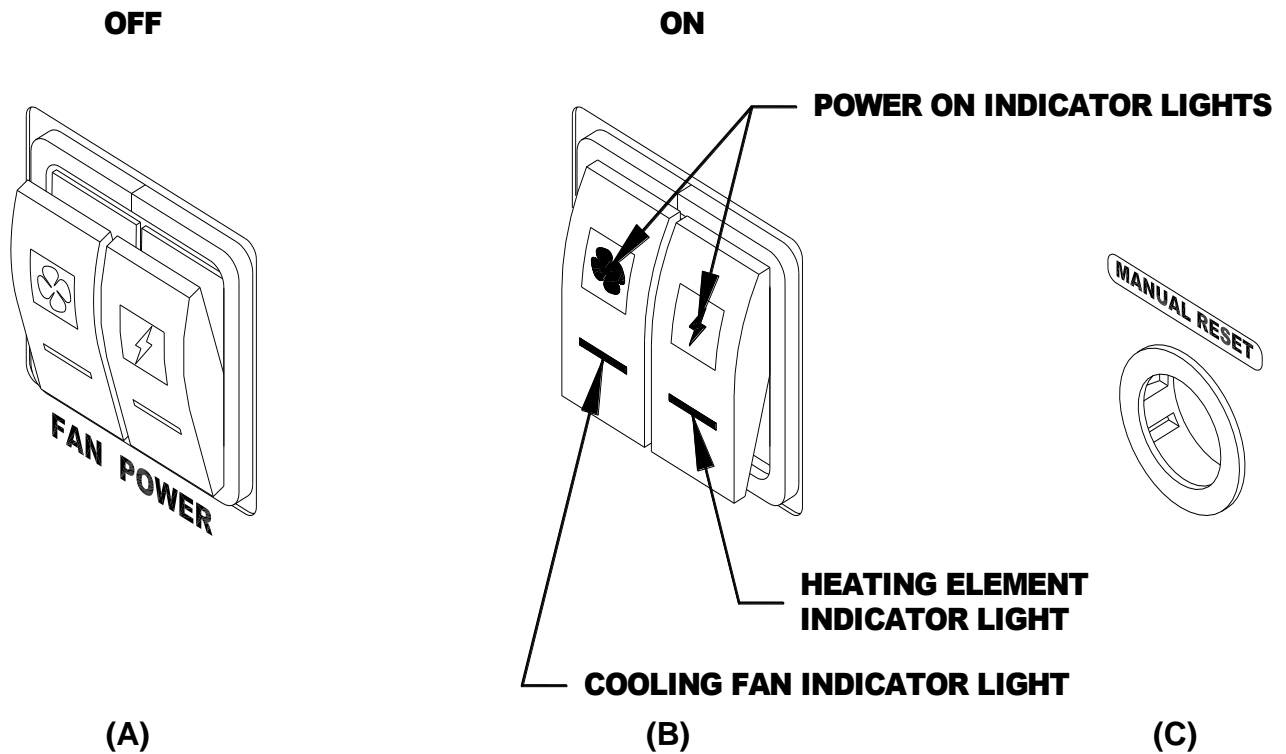

Operation Switches Diagram

Refer to the **Operation Switches Diagram** above. There are two black power switches **(A&B)** and one overheat manual reset switch **(C)** on the front of the water distiller head that allow you to control all functions of the water distiller

Power – ON/OFF

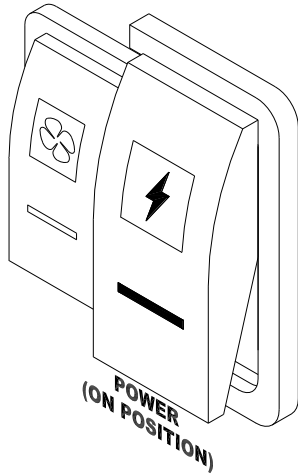

- Red indicator light.
- Normally ON when water distiller is operating. Controls power to the entire water distiller.
- Top square indicator light is illuminated whenever the switch is on. It will remain illuminated even when the water distiller is not operating.
- Bottom rectangular indicator light is illuminated only when the heating element in the boiler is on.
- Turn power switch to OFF to stop Water distiller operation.

Fan – ON/OFF

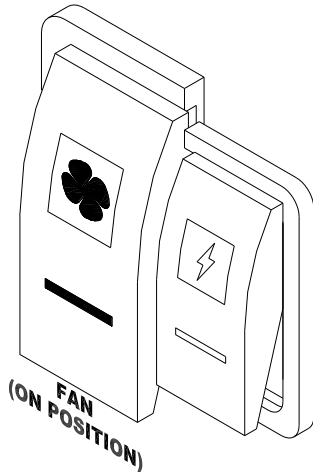

- Amber indicator light.
- Normally ON when water distiller is operating. Controls power to the cooling coil fan.
- Top square indicator light is illuminated whenever the power switch is on. It will remain illuminated even when the water distiller is not operating.
- Bottom rectangular indicator light is illuminated only when the fan is on. Fan should be running if the water distiller is distilling water.
- Turn Fan Switch to OFF when performing a steam sterilization of the water distiller.

Overheat Reset Switch – Manual Reset

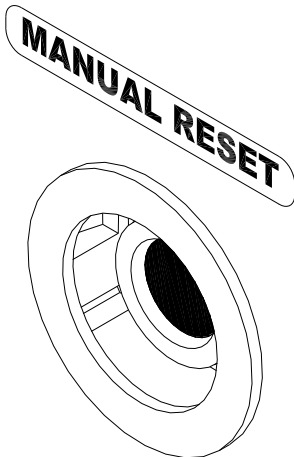

- Recessed into the front of the water distiller head front cover.
- The reset button will shut the unit off if the water distiller has overheated, it may be reset once the water distiller has cooled off. If the problem persists this may also indicate a problem and should be looked at by a service center.
- The reset button is a safety feature and is designed to shut the water distiller down should it overheat.
- Push your finger through the hole in the front cover labelled 'Manual Reset' to reset. A snap will be heard when the switch is reset and distilling can resume.

Before Initial Water Distiller Operation

Perform steam sterilization on the water distiller head, filter canister as described in the **Maintenance and Cleaning** section.

Normal Operation

1. Remove the lid from the Boiling Tank and ensure the drain is closed by turning the ball valve.
2. See the **Boiling Tank Water Level Fill Pin Diagram** below. Fill the boiling tank with water until the water reaches the bottom of the water gauge pin.

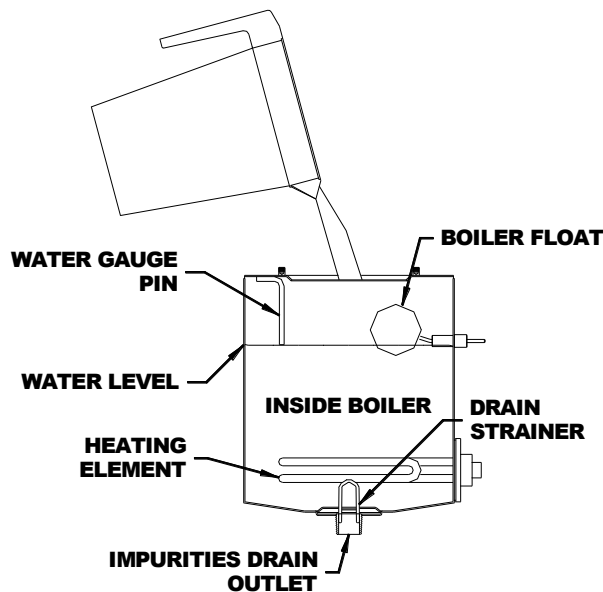

Boiling Tank Water Level Fill Pin Diagram

NOTE: Do not overfill the boiling tank, this will cause the raw water to enter the cooling coil and into your container.

3. Replace the lid back onto the boiling tank and tighten. The lid must be snug, but do not over tighten.
4. Turn the Power and Fan switches to the ON position.
5. Your water will now distil into the container of your choice. The distiller will shut down automatically when the water level is just above the heating element in the boiling tank.

6. When the distiller has stopped, you may refill the boiling tank with water.
Caution – The distiller will be very hot for several hours after shutting down.
7. To prevent a build up of scale and contaminants in the boiling tank, it is recommended that the impurities from the boiling tank be drained after at least every second distillation process. Routinely draining the impurities will prolong the life of the water distiller and reduce cleaning.

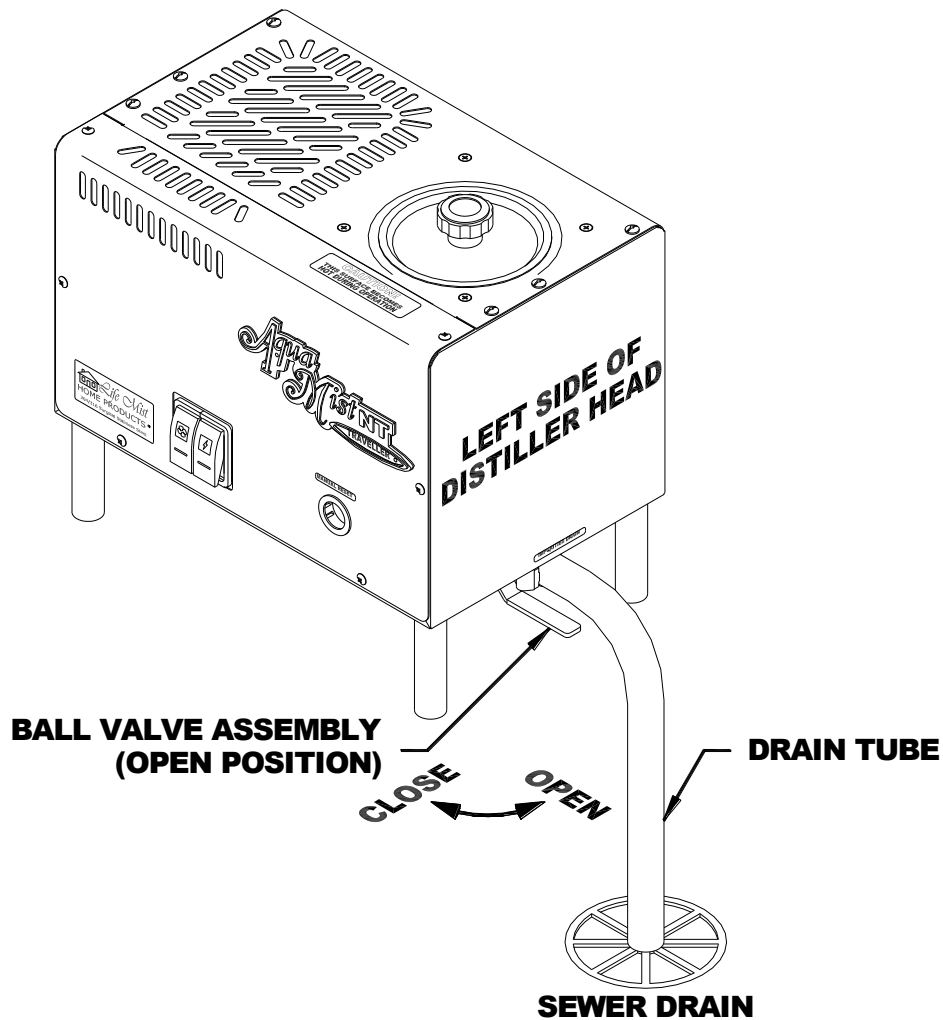

Manual Ball Valve Location Diagram

8. Refer to the **Manual Drain Faucet Location Diagram** above. The water distiller boiling tank can be drained by turning and opening the manual ball valve and draining into a suitable floor drain or container.

Maintenance and Cleaning

Introduction

The purpose of purchasing a water distiller is so you will not have to drink the unknown impurities in your drinking water. A water distiller effectively removes the impurities and chemicals from your water and returns the taste of pure water so that it is pleasing and healthy to drink for the entire family.

It is important to also keep the water distiller clean so that it can perform properly and efficiently. Regular cleaning and maintenance will allow the water distiller to continually provide pure water for a very long time.

NOTE: Regular Cleaning is much easier than trying to clean after a prolonged period of time!

Regular Inspection and Cleaning of the Boiling Tank

1. To prevent a build up of scale and contaminants in the boiling tank, it is recommended that the impurities from the boiling tank be drained after at least every second distillation process. There may be an off colour line at the seams of the boiler tank, this is caused by the TIG welding process used during manufacturing. This is normal and is not a sign of any concern.

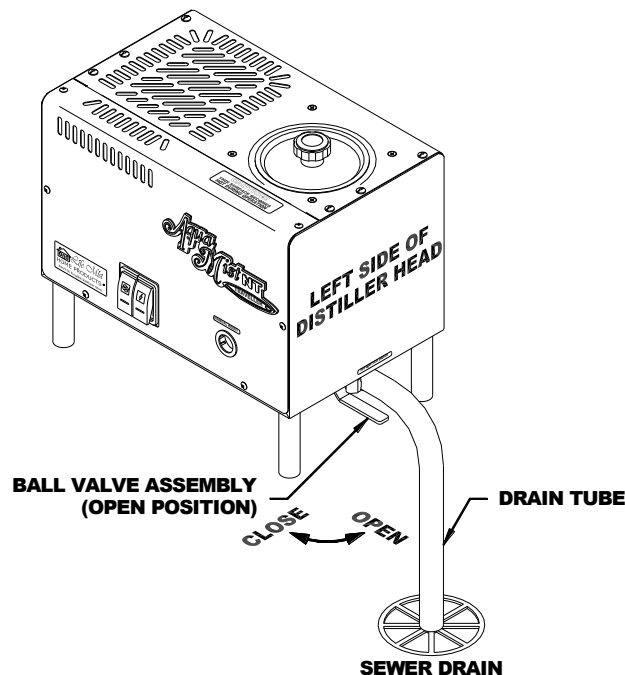

Manual Ball Valve Location Diagram

2. Refer to the **Manual Ball Valve Location Diagram** above. The water distiller boiling tank can be drained by opening the manual ball valve and draining into a suitable floor drain or container.
3. It is important to develop a regular maintenance routine.
4. Check for scale build up on the walls of the boiler tank and the heating element. The heating element is the most critical. If there is 1/8" of build up or more on the heating element, then it is time to clean the boiling tank using the cleaner descaler. This process is described in the next section.
5. After checking the boiling tank every two weeks for about three months, you will be able to set up your own schedule as to how often the boiling tank needs to be cleaned with the cleaner descaler. Distilled water quantity use and raw water quality will determine your schedule.

Cleaning the Boiling Tank using the Cleaner Descaler

1. Turn all switches off and allow the water distiller to cool down.
2. Remove any loose scale from inside the boiling tank by hand through the boiler lid. See **Steam Sterilization of Water Distiller Head** in this **Maintenance and Cleaning** section for more details.
3. Add 3 tablespoons of descaler cleaner to the boiling tank.

CAUTION:

- **Descaler is a corrosive and poisonous substance. Read safety precautions on the package.**
- **Always leave boiling tank lid off when ever the boiling tank is being descaled to reduce fumes travelling through the cooling coil.**
- **As the initial water is added to the descaler in the boiling tank it will produce a bubbling foam substance. Do not overfill the boiling tank.**
- **Dispose of the first gallon of distilled water as a precaution.**

4. Fill the boiling tank half full with hot tap water.
5. Mix the cleaning solution well to dissolve the descaler in the water.

6. Fill up the remaining portion of the boiling tank with hot tap water to the bottom of the water gauge pin. See **Boiling Tank Water Gauge Pin Diagram** below.

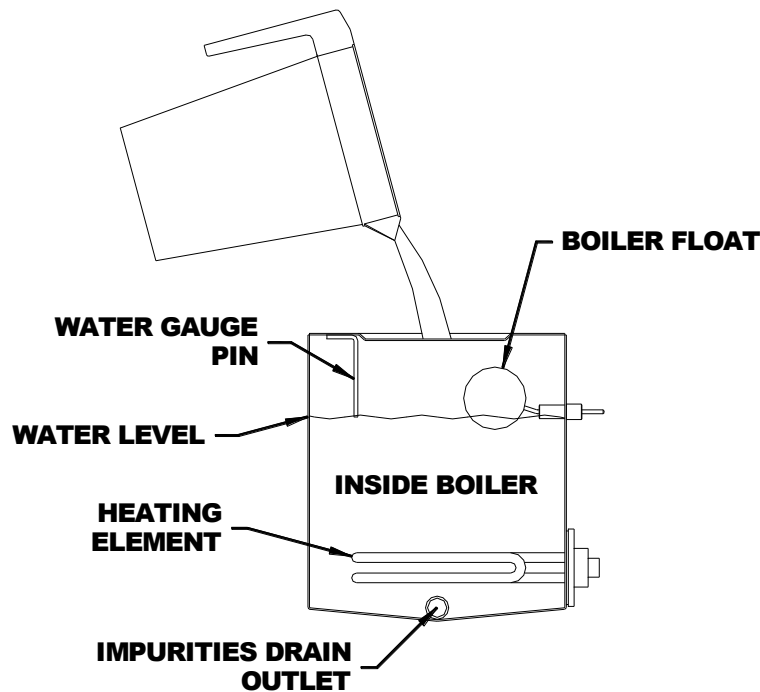

Boiling Tank Water Gauge Pin Diagram

7. Let the solution stand overnight. Leave the boiling tank lid off during cleaning to prevent descaler fumes from entering the cooling coil.
8. The next morning or when the mineral content is soft, drain the boiling tank using the drain valve. Remove any remaining loose scale by hand.
9. Repeat cleaning if necessary.
10. Once all the scale has been removed, rinse the boiling tank several times with warm tap water.
11. Complete steam sterilization process on the boiling tank. See **Steam Sterilization** in this **Maintenance and Cleaning** Section. Reinstall the filter canister.
12. The boiling tank is now clean and ready to produce pure water again.

Replacing Charcoal in Post Charcoal Filter

NOTE: Replace charcoal in filter every 2 months or every 500 gallons of distilled water.

1. Turn all switches off and allow the water distiller to cool down.

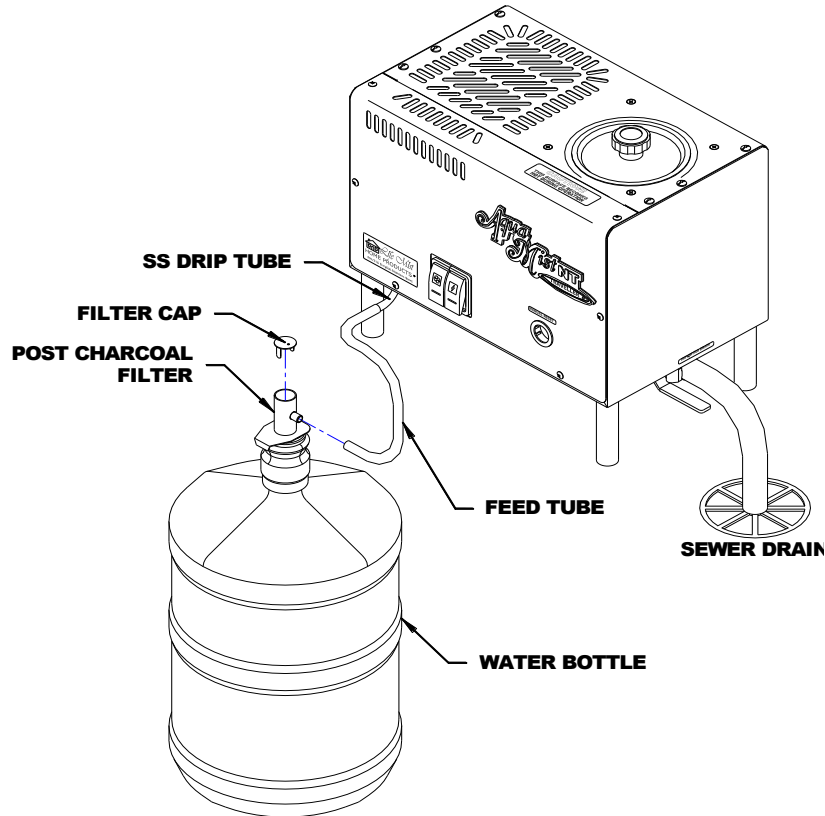

Post Charcoal Filter Charcoal Replacement Diagram

2. Refer to the **Post Charcoal Filter Charcoal Replacement Diagram** above. Remove the feed tube from the filter by pulling it off of the filter.
3. Over a sink or suitable garbage can, remove the lid of the filter completely and empty charcoal from canister and rinse.
4. Fill canister 2/3 full with new charcoal and rinse over a sink or pail with approximately 2 cups of distilled water until water runs clear.
5. Press the filter cap back on to the post filter canister.
6. Push the feed tube onto the tube on the side of the filter canister.
7. Place the filter inside of any storage container or bottle.

Sterilization

Introduction:

Steam Sterilization should be performed on the water distiller boiler before the water distiller is used for the first time or after a period of storage or non-use. After initial sterilization, the boiler should be steam sterilized after any maintenance is performed and/or cleaning including the descaling process.

If there is a water quality concern and the system may be contaminated, it is important to first remove the source of contamination and remove all contaminated debris and then complete a Liquid Sterilization before a Steam Sterilization.

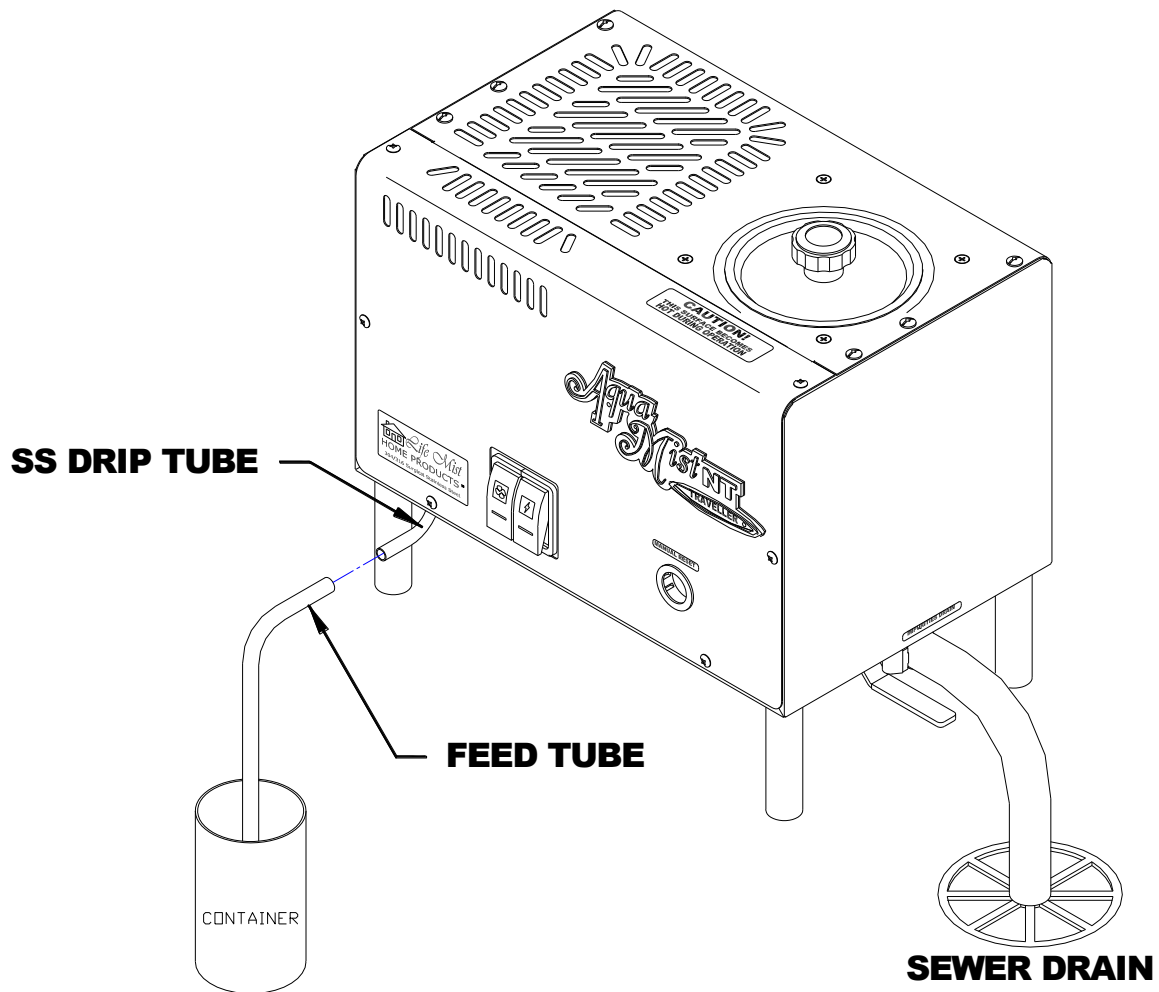

Steam Sterilization of Water Distiller Head

1. Make sure the water distiller is cool before starting.
2. Refer to the **Steam Sterilization Diagram** above. Install the sterilization tube. Place the sterilization tube on the 3/8" stainless steel tube on the bottom of the water distiller head.
3. Place the other end of the steam sterilization tube into a container as it will drip water and steam.
4. Fill the boiling tank with water to the bottom of the water gauge pin.
Steam Sterilization Operation Switches Diagram
5. Refer to **Steam Sterilization Operation Switches Diagram** above. Turn only the power switch ON. Leave the fan switch OFF. As the water distiller continues to heat up, it will sterilize the water distiller with steam by allowing pure steam to travel out of the cooling coil. Water and steam will drip from the sterilization tube. **Caution: The Water Distiller is extremely hot during sterilization.**
6. Leave the water distiller on for 1 hour.
7. After the sterilization cycle is complete, turn the fan switch ON and allow any water in the cooling coil to drain. Leave the water distiller running with the fan on for about 15 minutes.
8. The water distiller will be very hot so turn all switches OFF (power and fan) and let the water distiller cool down for approximately 1 hour.
9. Remove the sterilization drip tube by pulling the plastic tube off the stainless steel charcoal filter inlet tube (keep the sterilization tube for future sterilizations).
10. Replace the charcoal in the post charcoal filter canister. See **Replacing Charcoal in Post Charcoal Filter Canister** The water distiller head is sterilized and ready for operation.

Steam Sterilization of Water Distiller Head, Filter Canister

1. Make sure the water distiller is cool before starting.
2. Refer to the **Steam Sterilization Diagram** in the previous section-**Steam Sterilization of Water Distiller Head**.
3. Remove the charcoal filter canister. Remove all charcoal and rinse until clean. Replace empty filter. Place a container under the tube.

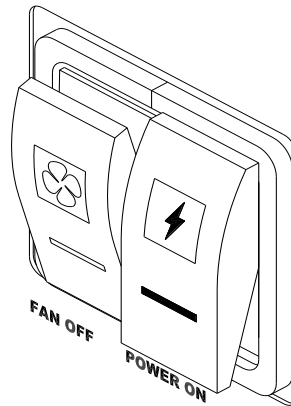

Steam Sterilization Operation Switches Diagram

4. Refer to **Steam Sterilization Operation Switches Diagram** above. Turn only the power switch ON. Leave the fan switch OFF. As the water distiller continues to heat up, it will sterilize the water distiller head, filter canister with steam by allowing pure steam to travel out of the cooling coil. Water and steam will drip from the tube. **Caution: The Water Distiller is extremely hot during sterilization.**
5. Leave the water distiller on for 1 hour.
6. After sterilization cycle is complete. Turn the fan switch ON and allow any water in the cooling coil to drain. Leave the water distiller running with the fan on for about 15 minutes.
7. The water distiller will be very hot so turn all switches OFF (power and fan) and let the water distiller cool down for approximately 1 hour.
8. Replace the charcoal in the charcoal filter canister. See “**Replacing Charcoal in Charcoal Filter Canister**” in this **Maintenance and Cleaning Section**.
9. The water distiller head, filter canister are sterilized and ready for operation.

Maintenance Schedule Table

	Initially	Weekly	Monthly	Semi-Annually	Annually	As Needed
1) Check Scale Build Up.		X				X
2) Change Charcoal in Charcoal Filter Canister.	X		X			X
3) Clean Boiling Tank using Cleaner Descaler.			X			X
4) Steam Sterilization of Boiling Tank after cleaning.						X
5) Steam Sterilization of Boiler Tank.	X					X

Owner Maintenance Record Table

	Change Charcoal in Charcoal Filter Canister	Clean Boiling Tank using Cleaner Descaler	Steam Sterilization of Boiling Tank	Steam Sterilization of Boiling	
Date	Jan 21/03				
Completed By	BDR				
Date					
Completed By					
Date					
Completed By					
Date					
Completed By					
Date					
Completed By					

Troubleshooting

Caution! Always Disconnect Water Distiller Electrical plug and let the Water Distiller cool down completely *before* completing any Troubleshooting.

PROBLEM	PROBABLE CAUSE
<p>A) Water distiller does not operate.</p>	<ol style="list-style-type: none"> 1. Water distiller is not plugged in securely to the wall outlet or the circuit breaker is off. 2. Power switch on the water distiller is turned off. 3. Reset button has shut the unit off. The reset button will shut the unit off if the water distiller has overheated, it may be reset once the water distiller has cooled off. This may also indicate a problem and should be looked at by a service center. The reset button is a safety feature and is designed to shut the water distiller down should it overheat. Push your finger through the hole in the front cover labelled 'Manual Reset' to reset. It will snap once reset. 4. Reset button is faulty and needs to be replaced. Call Service Center.
<p>B) Water is coming out from the top of the charcoal filter.</p>	<ol style="list-style-type: none"> 1. Charcoal is old and compacted. Replace coconut charcoal. See Maintenance section- Replacing Charcoal in Charcoal Filter Canister. 2. Charcoal filter is more than 2/3 full. There must be an air gap between the charcoal and the top of the filter. Remove Charcoal filter and make sure charcoal filter is only 2/3 full.
<p>C) Steam or water is escaping from the top of the cooling coil.</p>	<ol style="list-style-type: none"> 1. The cooling coil is equipped with a gas release vent, a very small hole in the top of the coil. This is to release certain volatile gases. Steam may escape from this hole. This is normal. 2. If little or no water is being produced the cooling coil may have become disconnected from the boiling tank. Call Service Center.

PROBLEM	PROBABLE CAUSE
D) Charcoal Filter is very hot and steam is escaping from the filter.	<ol style="list-style-type: none"> 1. The fan switch is turned off. Check Switch. 2. Fan motor is not running properly, may be defective, or the fan motor switch may be defective. Call Service Center. 3. Cooling coil fins are plugged with dust, dirt, or grease. Remove and clean or take to a service center for maintenance. 4. The location of the water distiller does not provide enough airflow for good cooling. Move the water distiller to an area with more air movement.
E) Water distiller may start to boil, then shuts off. It may restart after cooling down. Very small amount of water is produced.	<ol style="list-style-type: none"> 1. Faulty Reset button. After letting water distiller cool down and trying to reset several times, call Service Center.
F) Water distiller runs properly but little or no water is produced.	<ol style="list-style-type: none"> 1. Improper Heating Element is installed or Heating Element is faulty. Call Service Center. 2. Boiler tank lid is loose. Check by moving Boiler Tank Lid Knob. 3. Reset button may be defective or weak. See A) 3 above.
G) Strange taste in Distilled Water.	<ol style="list-style-type: none"> 1. Boiling tank may require cleaning. See maintenance section on cleaning water distiller. 2. Boiling tank was over filled. 3. Charcoal filter requires new Coconut Charcoal.
H) Fan does not operate automatically.	<ol style="list-style-type: none"> 1. Fan switch is in OFF position. Check Switch. 2. Fan motor may be defective. Call Service Center.
I) Distiller does not seem to produce as much water as specified.	See Section in Guide: 10 Factors That Will Affect Your Water Distiller Production.

Contact any LifeMist Water Systems Service Center to correct any problems with your water distiller that are not covered in this guide.

To locate a Service Center in your area contact LifeMist at:

LifeMist Home Products.
10331-105 St.
Westlock, AB Canada
T7P 2H7
<http://www.lifemist.com>

Phone: (780) 349-4992 FAX: (780) 349-4957

Additional Options

Water Distiller Cleaner and Descaler

600 Gram jar - #530162

1600 Gram jar - #530163

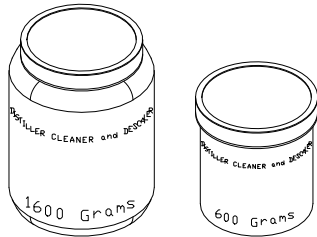

Used for regular maintenance to clean the scale out of the boiling tank. Dissolves water minerals in water distillers, coffeepots, dishwashers or most metal products where water scale is a problem.

Pure Activated Coconut Charcoal for Refillable Charcoal Filter Canisters

250 Gram jar - #530160

600 Gram jar - #530161

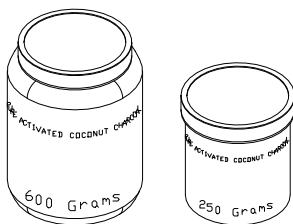

Contains 100% pure crushed coconut shells that have been steam activated at extremely high temperatures creating a porous grade of activated charcoal. This coconut charcoal can be used along with any type of home or commercial water distiller. Coconut charcoal is used to trap any gases or obnoxious odors that may escape the distillation process. Do not use any other charcoal such as aquarium type.

Specifications and Technical Information

Model	Traveller
Electrical Specifications Voltage Amperage Power Frequency	120VAC 9.2 Amps 1100 Watts 60 Hertz
Water distiller Physical Size Height-w/ lid -w/o lid Width-w/ drain valve Depth-	14-1/4"(34.3 cm) 15" (33.0 cm) 18" (45.7 cm) 10-5/8"(27.0 cm)
Water distiller Weight Dry: Water distiller Only	25 lbs. (11 kg)
Water distiller Production Capacity Approx. Prod. Capacity Approx. Daily Prod. Capacity	0.3 US gal/h (1.2 L/h)* 8 US gal (30.0 L)/24 hrs.

***Note:** Performance based on optimum conditions including water temperature, ambient temperature, line voltage, boiling tank cleanliness, boiler fill level, etc.

Wiring List (8GPD Manual) Part # 500246-								
No.	Part#	Color	Ga	Length	From Conn.	To Conn.	From Location	To Location
						SERIES 15		
1	500287	GRN	16	3"	#10RING#14-#16	POWER CORD	GROUND	POWER CORD
2	500287	BLK	16	14"	F250 #14-#16	POWER CORD	POWER SWITCH #2	POWER CORD
3	500287	WHT	16	16"	#10RING#14-#16	POWER CORD	RESET SWITCH #2	POWER CORD
4	500395	BLK	18	8"	F250#18-#22&PIGG#18-#22	FAN MOTOR (ORG/BLU)	FAN SWITCH #2	FAN MOTOR
5	500395	BLK	18	12"	2 (#10RING#18-#22)	FAN MOTOR (YLW/WHT)	RESET SWITCH #4	FAN MOTOR
6	095103	BLK	16	9"	F250 #14-#16	#10 RING #14-#16	MICROSWITCH "NC"	HEATING ELEMENT B
7	095024	YLW	16	6"	#10RING#14-#16	#10 RING #14-#16	RESET SWITCH #3	HEATING ELEMENT A
8	095025	WHT	16	12"	F250 #14-#16	#10 RING #14-#16	FAN SWITCH #3	HEATING ELEMENT B
9	095104	RED	16	7"	F250 #14-#16	#10 RING #14-#16	MICROSWITCH "COM"	RESET SWITCH #1
10	095027	ORG	16	9"	F250 #14-#16	#10 RING #14-#16	POWER SWITCH #3	RESET SWITCH #4
11	095028	GRN	16	9"	F250 #14-#16	#10 RING #14-#16	POWER SWITCH #8	RESET SWITCH #1
12	095029	BRN	16	9"	F250 #14-#16	#10 RING #14-#16	FAN SWITCH #6	RESET SWITCH #4
13	095010	WHT	16	3"	PIGG #14-#16	F250#14-#16	FAN SWITCH #2	FAN SWITCH #7
14	095010	WHT	16	3"	PIGG #14-#16	F250#14-#16	POWER SWITCH #3	POWER SWITCH #6
15	095031	BRN	16	13"	F250 #14-#16	#10 RING #14-#16	POWER SWITCH #7	HEATING ELEMENT B
16	095032	BLU	16	10"	#10RING#14-#16	F250 #14-#16	RESET SWITCH #3	FAN SWITCH #8

WIRING DIAGRAM, 8GPD MANUAL

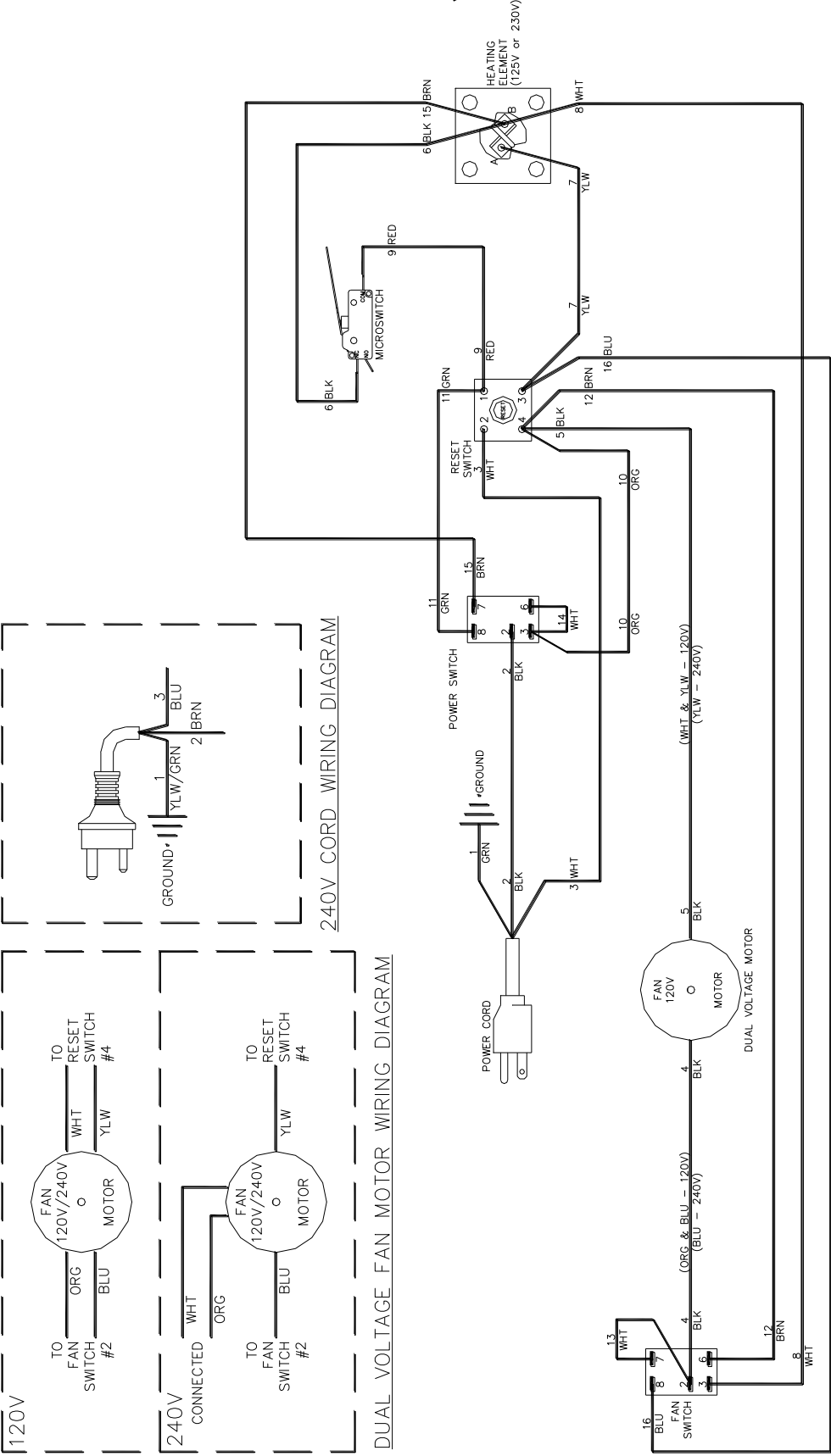

Index

- Boiling Tank Lid, 18
- Capacities
 - distilled production, 34
- Charcoal
 - changing, 26
- Charcoal Filter
 - Installing Canister, 26
- Charcoal Filter Canister
 - replacing charcoal, 26
- Cleaning
 - boiling tank using the cleaner descaler, 24
 - regular inspection/cleaning of the boiling tank, 23
- Descaler
 - instructions, 24
- Electrical
 - location, 12
 - requirements, 12
- Hydrological Cycle, 11
- Inspection-boiling tank, 23
- Installation
 - drain tube, 17
 - water distiller tools, 15
- Lid
 - boiling tank, 18
- Location-suitable distiller, 12
- Maintenance and Cleaning, 23
 - record table, 30
 - schedule, 30
- Operation, 19
 - fan switch, 20
 - normal, 21
 - overheat reset switch, 20
 - power switch, 20
- Options
 - charcoal-replacement order, 33
 - cleaner and descaler-replacement order, 3300
- Post Charcoal Filter
 - replacing charcoal, 26
- Record of purchase, 4
- Safety Precautions, 6
- Service Center Locator, 32
- Shipping Tie Removal, 15
- Startup- Summary, 7
- Sterilization, 27
 - steam- water distiller head, 28
 - steam- water distiller head, filter canister , 29
- Terminology, 8
- Troubleshooting, 31
- Warranty, 5
- Weights, 34